



6 Kestral Street CLAREMONT, TAS



3



1



4

## GREAT STARTER OR INVESTMENT OPPORTUNITY

This home is calling out to all first home buyers and investors, come and have a look at the package on offer here. This weatherboard home is perfectly positioned almost directly across the road from the Knight Point Reserve. This quiet locale also offers close proximity to the river Derwent beyond the reserve. You can even hear the waves lapping and birds calling from the front porch.

The spacious kitchen offers a view to the rear yard and offers stainless appliances and a dishwasher. The kitchen offers a combination of both under and over mounted cupboards.

The lime feature walled bathroom has been modernized and offers a bath with shower over an

**Mel Shutt**

Property Consultant

0428428884

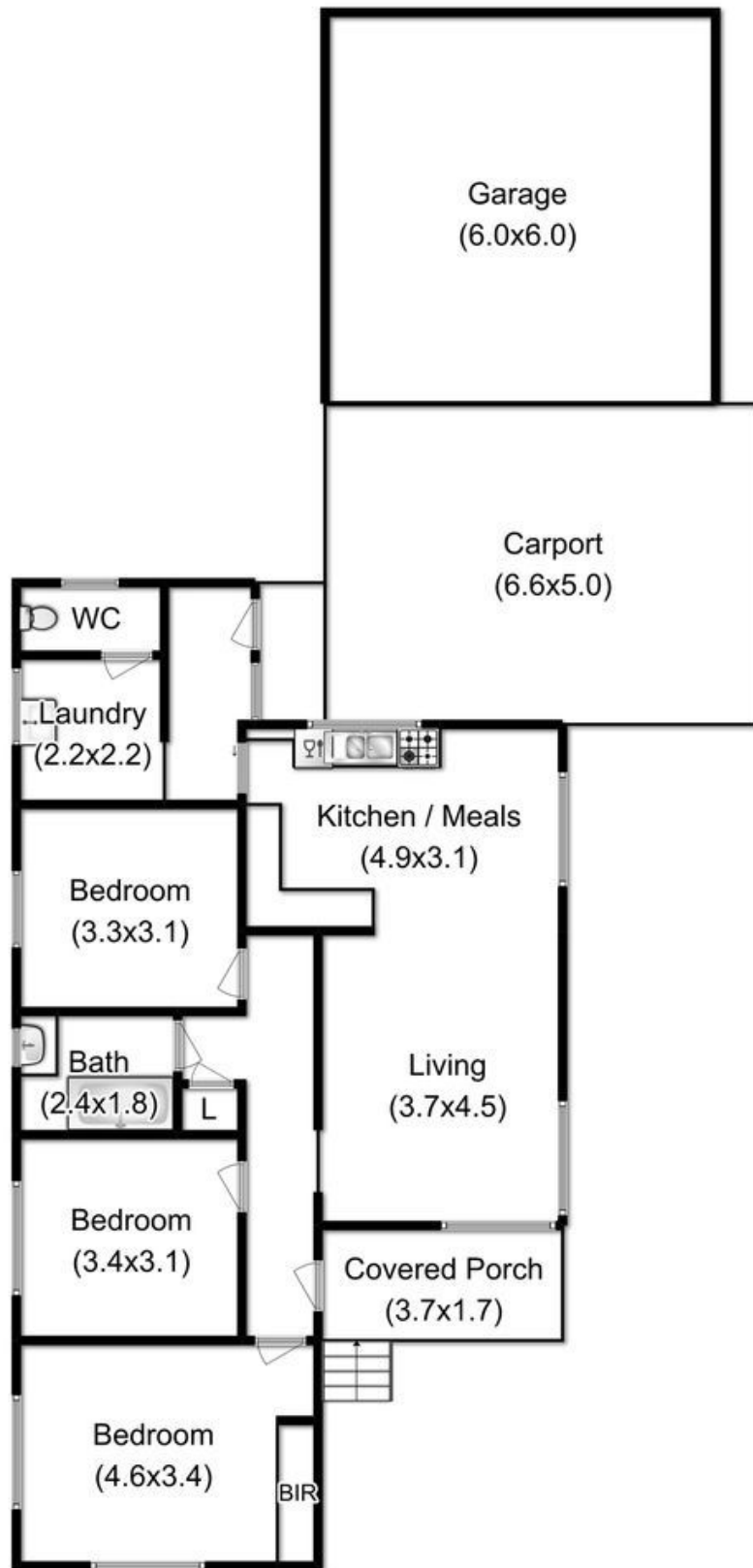

Total Approx. Outbuilding Area : 36.0 m<sup>2</sup>

Total Approx. Floor Area : 101.7 m<sup>2</sup>



Fixtures & Fittings for display purposes only, not to scale  
Produced by Open2view.com