



14 Louise Road AUSTINS FERRY, TAS



SOLD

Attractive three bedroom Brick and Tile home with lots of space under to allow all family members to chill out in their own space!

Upon entry to the home you are welcomed inside with beautifully polished floor boards, an array of bright feature walls and a spacious entry foyer. The polished floors lead you directly into the open plan dining and kitchen arena which is highlighted by the wonderful choice of feature wall colours.

Very good OSP for two vehicles, a wonderful covered entertainment area and two sheds complete this great package.

This is a family friendly home and if you are looking for a home with space and good size

Ollie Wuttke

0414 851 192

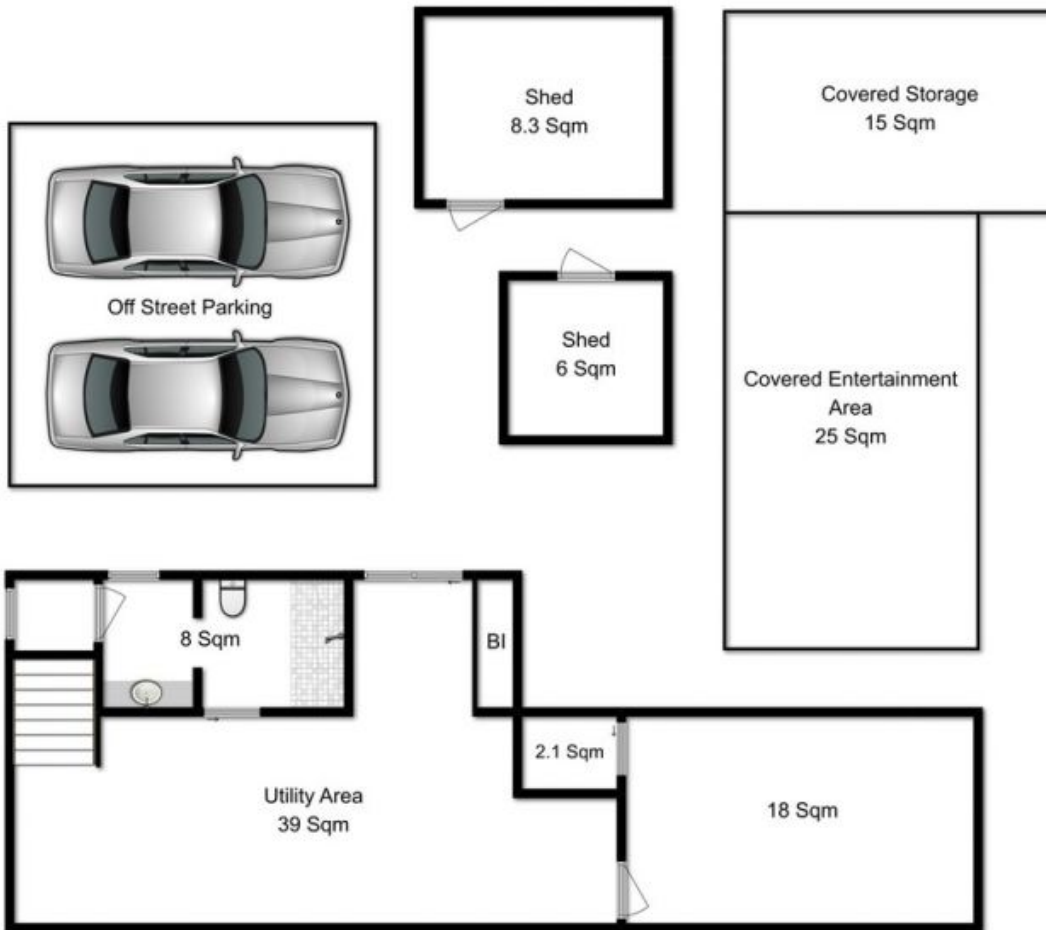

Ground Floor



Entrance Floor
Approx Floor Area 112 Sqm

Fixtures And Fittings are for display only, not to scale.
This floor plan is a sketch, dimensions are approximate.
Produced by open2view.com