



221 Briggs Road HONEYWOOD, TAS



PICTURE POSTCARD COUNTRY COTTAGE

Perfectly positioned to capture picturesque views of rolling green pastures and bathed in all day sun this character timber home is sure to attract the attention of savvy first home buyers or those looking for an idyllic retreat within an easy commute to Hobart.

The style of the home is a timeless country classic with clever use of Tasmanian timber throughout. The home features three good sized bedrooms, spacious family living area, recently renovated open plan kitchen and bathroom.

This is a truly exceptional property that is worthy of inspection.

"We have obtained all information in this document from sources we believe to be reliable;

Stuart Thiessen

0408 237 851

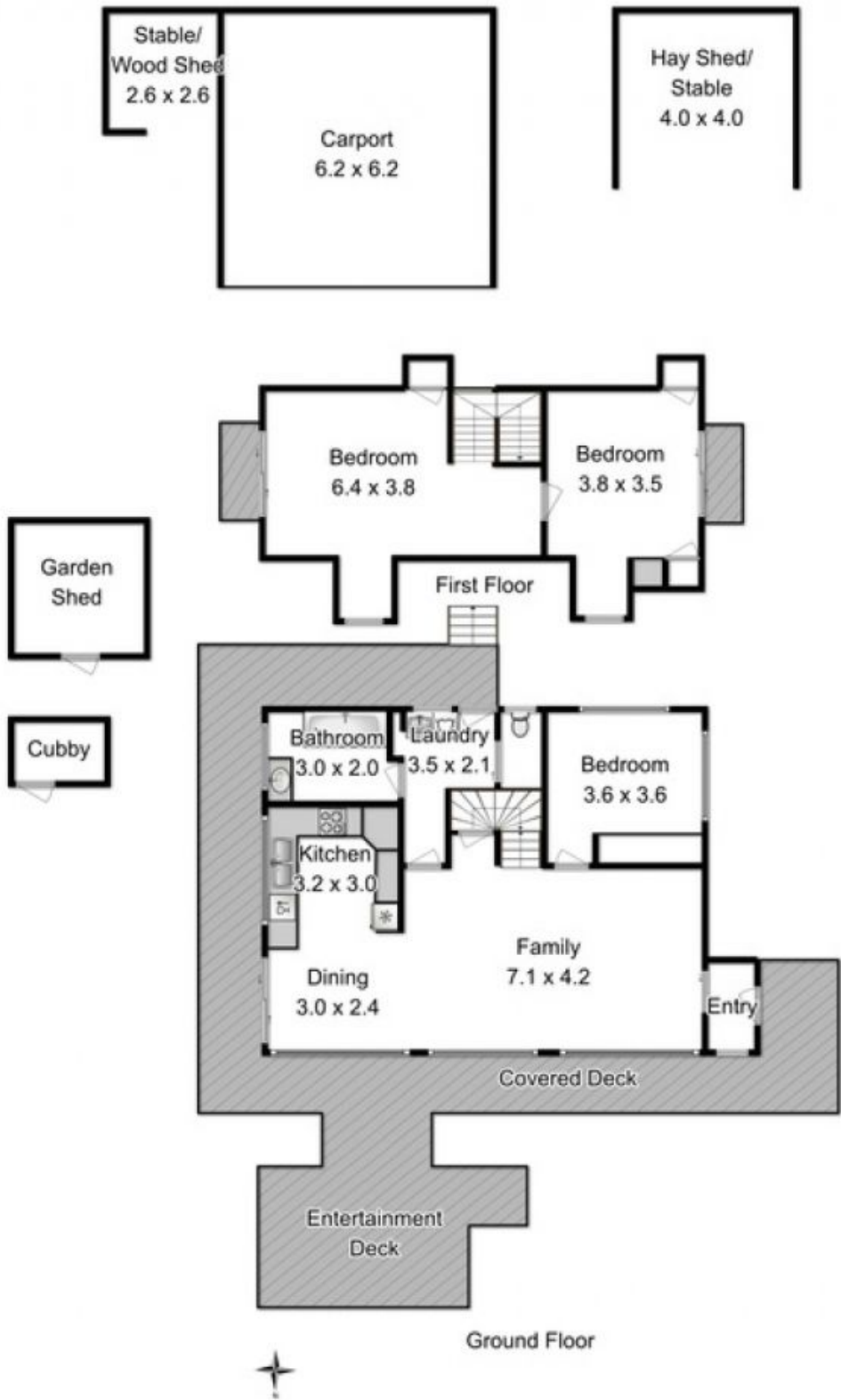

Approx. Floor Area: 132 Sqm

Fixtures and Fittings are for display only and not to scale.
 This floor plan is a sketch for illustration.
 All measurements are internal and approximate.
 Produced by open2view.com