



24 Milton Crescent MOONAH, TAS



RESIDE OR INVEST BEAUTIFULLY RENOVATED HOME

Desirably located in a quiet street and immaculately presented with recent updates throughout, this three bedroom home offers an excellent opportunity to break into the market or invest in the hotly contested suburb of Moonah.

Outside, a low maintenance landscaped front yard accommodates 2 x OSP and the backyard is well fenced and safe for children and pets. The adjacent park with play equipment is a great bonus for younger members of the family!

With a growing array of cafes and restaurants in addition to the arts centre and shopping precinct, Moonah is increasingly popular amongst professional couples and young families seeking quality homes within easy reach of the CBD. With all the hard work already done fo

Council Rates: \$1,294.00/year (approx)

Water Rates: \$800.00/year (approx)

Stuart Gifford

Property Consultant

0419337054

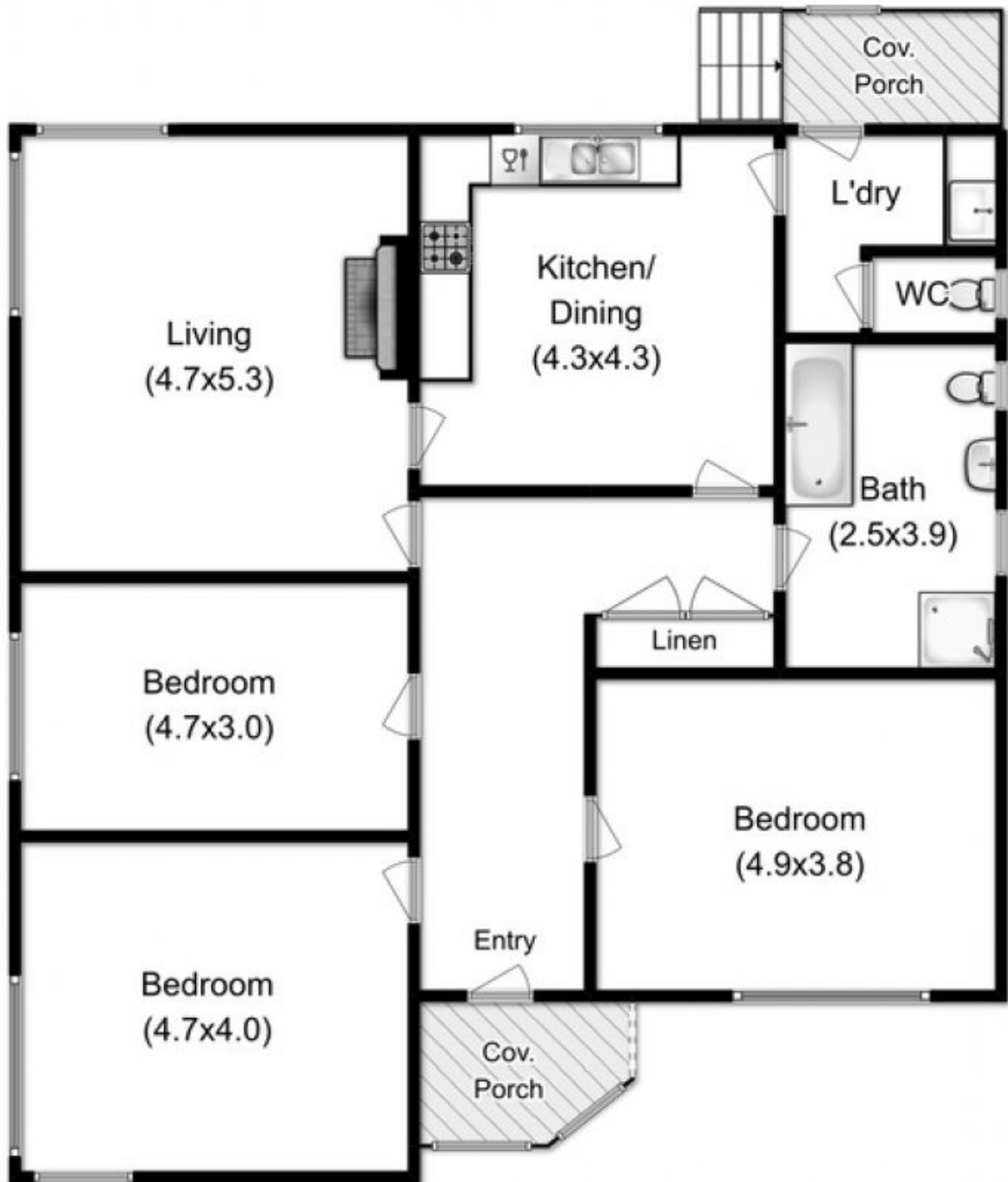

Total Approx. Floor Area : 135 sqm



All measurements are internal and approximate.
 This plan is a sketch for illustration, not valuation.
 Produced by Open2view.com