

24 Loinah Crescent MONTAGU BAY, TAS



4



2



2

QUALITY FAMILY HOME WITH STUNNING RIVER AND MOUNTAIN VIEWS

Boasting magnificent views of the River Derwent and Mount Wellington, this sun drenched and light filled spacious family home will appeal to purchasers seeking comfortable and convenient living in a great location.

An open plan dining room and kitchen offers further living space, with a well-equipped kitchen with quality joinery and dishwasher. This area connects seamlessly to the landscaped rear yard via a glass sliding door opening onto a covered and sheltered patio.

The master suite has an ensuite bathroom and BIR. Two additional bedrooms, both with BIR are serviced by a central family bathroom and separate WC. The lower level accommodates a study in addition to a double garage with extensive storage capacity for those requiring additional space for hobbies or trades. Surrounded by meticulously kept landscaped gardens

Penny Trewin

0408 505 470



Approx. Ground Floor Area: 148 Sqm

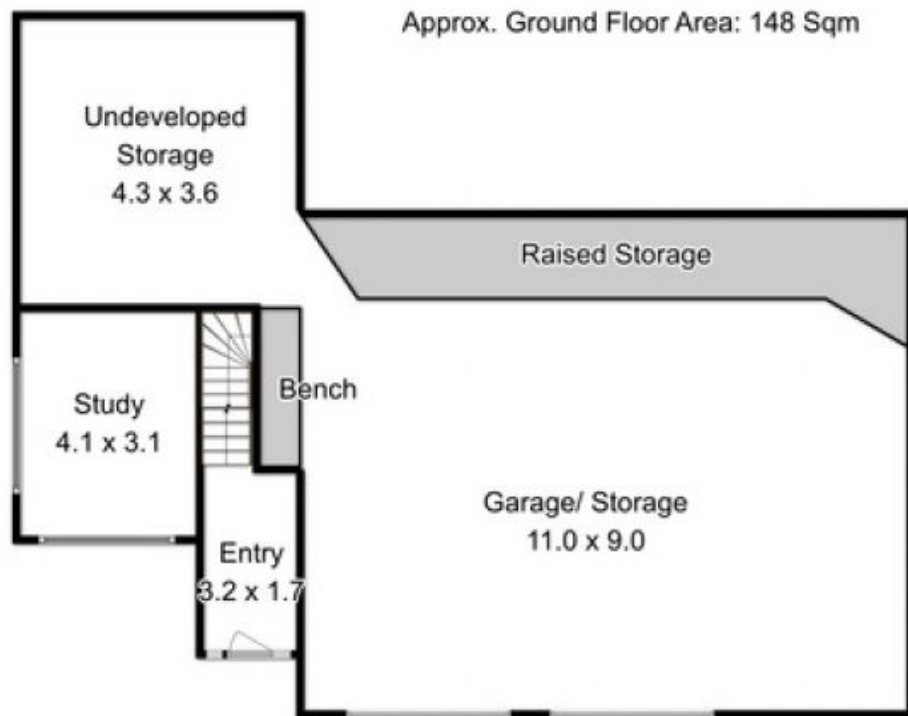

Approx. Lower Ground Floor Area: 156.3 Sqm



Fixtures and Fittings are for display only and not to scale.

This floor plan is a sketch for illustration.

All measurements are internal and approximate.

Produced by open2view.com