



69 Collins Cap Road COLLINSVALE, TAS



4



2



3

COUNTRY CHARM WITH ACREAGE

Welcome to "Clifton". This lovely historic family home is set on approximately ten acres and is steeped in local history.

On offer is a lifestyle often dreamed of this property is quiet, peaceful has bags of character and all within a short 15 minute drive to Glenorchy CBD and 30 minute drive to Hobart CBD.

The home itself has a relaxed feel with a layout that is very much of the era it was built in and features Tasmanian Oak floors, high skirtings, ceiling roses, picture rails & gorgeous wooden mantle pieces.

The main living areas are large, bright, and open and get lots of sun coming in throughout the day. The bedrooms are all of a very generous size, with the main bedroom having an ensuite bathroom. The wrap around veranda at the front of the home takes in some superb views out over the garden and the surrounds. The property also features a garage/workshop, c

Stuart Thiesen

0408 237 851

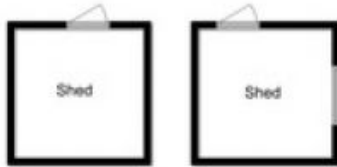
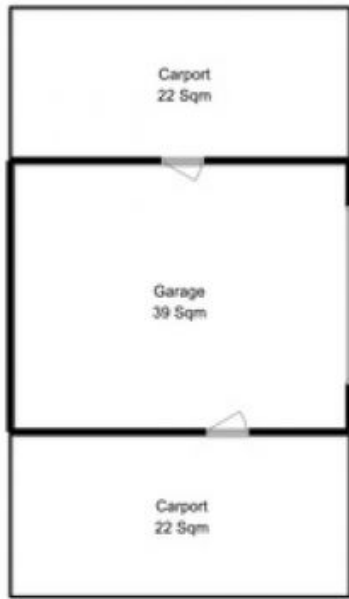

Approx Floor Area 197 Sqm



Fixtures & Fittings are for display only, not to scale.
Produced by Open2view.com

