



45 Hudson Crescent GLENORCHY, TAS



FIRST TIME OFFERED TO THE MARKET IN OVER 30 YEARS!

Get ready to make your mark on this terrific home - offered to the market for the first time in over 30 years.

For home buyers who are looking to find a centrally located property with great bones that they can add their own special touches to this is one not to be missed.

This home is in well maintained condition throughout and would not take a lot of effort to transform it into a home with more modern day styling.

Under the carpeting there are untouched Tasmanian Oak floor boards screaming out to be polished!

From the entry hall at the front of the home is a sunny lounge that overlooks the leafy fr

Council Rates: \$1,200.00/year (approx)

Water Rates: \$1,000.00/year (approx)

Stuart Gifford

Property Consultant

0419337054

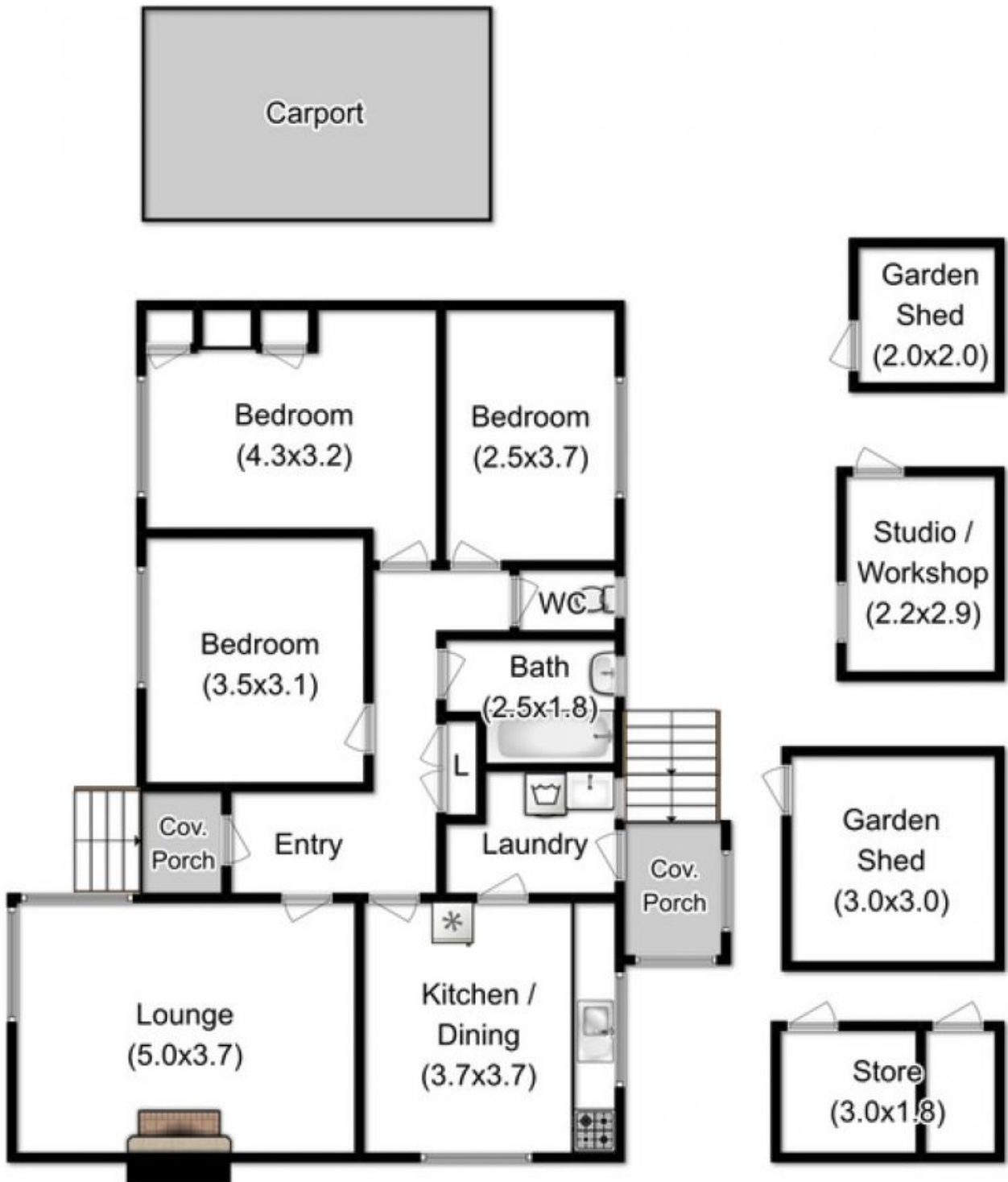

Total Approx. Floor Area : 95 sqm
 Total Approx. Outbuilding Area : 28 sqm



All measurements are internal and approximate.
 This plan is a sketch for illustration, not valuation.
 Produced by Open2view.com