



336 Manuka Road KETTERING, TAS



1



1

TRANQUIL AND SERENE POSITION - ULTIMATE LIFESTYLE ON OFFER

Be impressed with the opportunities on offer with this 'Taj Ma Shed' set on a beautiful north facing 2 hectare property in one of Tasmania's beautiful settings in Kettering.

Move in and enjoy a 120 sqm Ranbuild shed, 60 sqm is a Class 1A council approved permanent dwelling consisting of a carpeted one bedroom, a lovely large tiled open plan living/dining/kitchen area with a wood heater and a combined laundry/bathroom with shower, vanity, toilet. The remaining 60sqm is storage/garage with 3 phase power connected a man's dream!

Council Rates: \$1,225.00/year (approx)

Katrina Arkley

0407 691 077

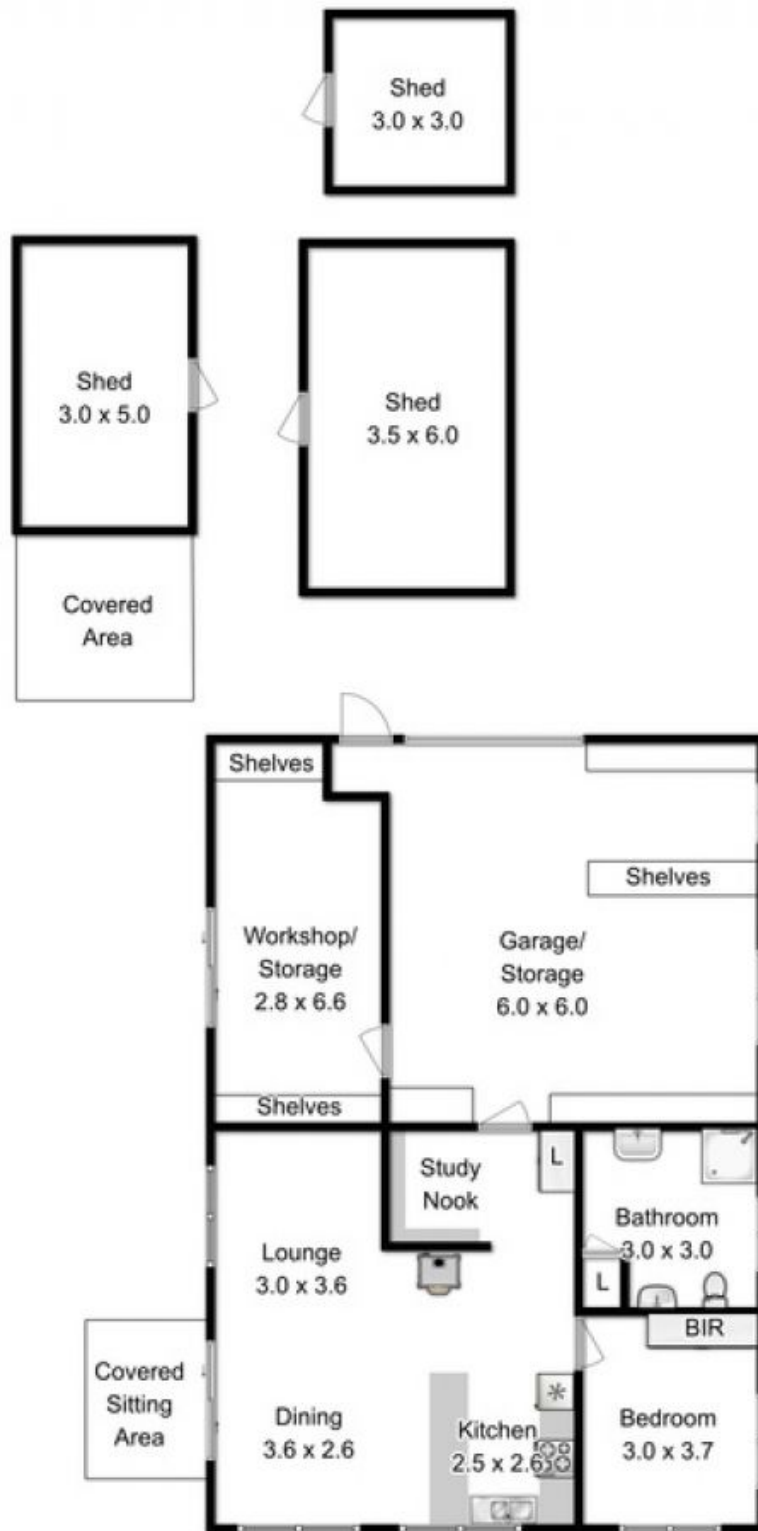

**Approx. Floor Area: 121 sqm
(excludes sheds)**

Fixtures and fittings are for display purposes only,
not to scale.

Produced by Open2view.com



RIPPLE