

30 Garden Road MOONAH, TAS



## FEDERATION RENOVATOR FIRST TIME OFFERED IN OVER 60 YEARS ON 1156M2 OF LAND!

Garden Road is one of Moonah's most highly sought streets because it is filled with period homes on larger blocks and is convenient to great local schools, shops, cafes and only a short drive to Hobart's CBD.

We are privileged to offer a home that has been tightly held by the same family for over 60 years who have ensured this home has retained all of the high Federation features throughout including wide skirting boards, high ceilings, leadlight windows, exposed boards, four panel doors and box bay windows.

In keeping with the period of the home the property offers rooms in larger proportions throughout including a large sunny formal dining room which adjoin the small galley style kit

**Stuart Gifford**  
Property Consultant

0419337054

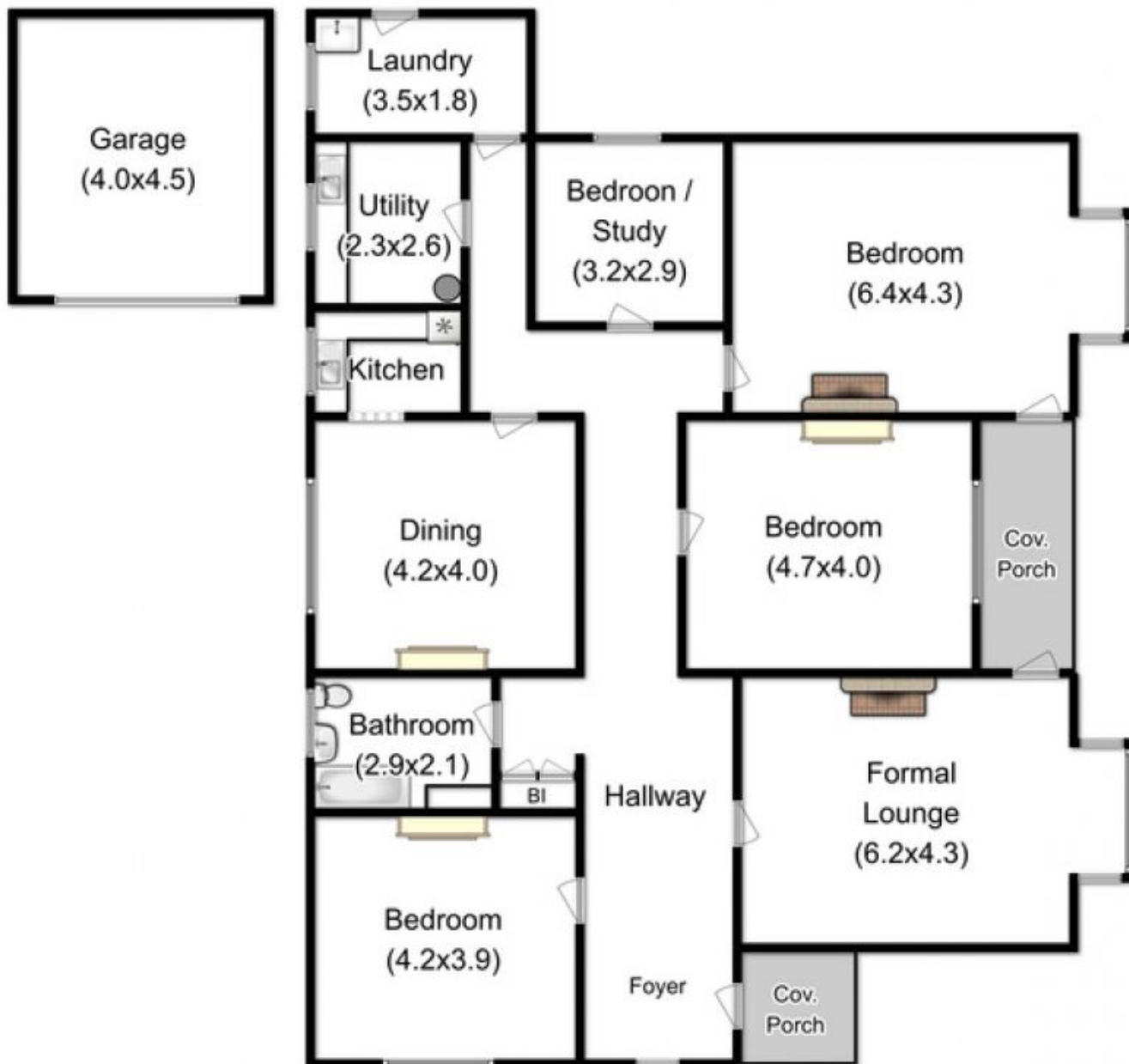

Total Approx. Floor Area : 180 sqm  
 Total Approx. Outbuilding Area : 18 sqm

All measurements are internal and approximate.  
 This plan is a sketch for illustration, not valuation.  
 Produced by Open2view.com