



38 Lindhill Avenue GEILSTON BAY, TAS



4



2



1

A HOME THE WHOLE FAMILY WILL LOVE

Enjoying a sunny and elevated position, this solidly built brick home ticks all the boxes for modern family living. With a flexible floorplan and multiple living areas this is a property that will accommodate your family at every stage, offering convenience and comfort.

Positioned on 726sqm, the property enjoys a dual driveway, carport for OSP and there is an undercover outdoor entertaining area for hosting family and friends.

Close to Lindisfarne North Primary school, public transport and Lindisfarne Village and Eastlands, and only a short drive to the Hobart CBD, this is a property will appeal to discerning purchasers seeking a low maintenance, quality family home within easy reach of everything a family could want or need! Quality homes like this are snapped up quickly in the

Mel Shutt

Property Consultant

0428428884

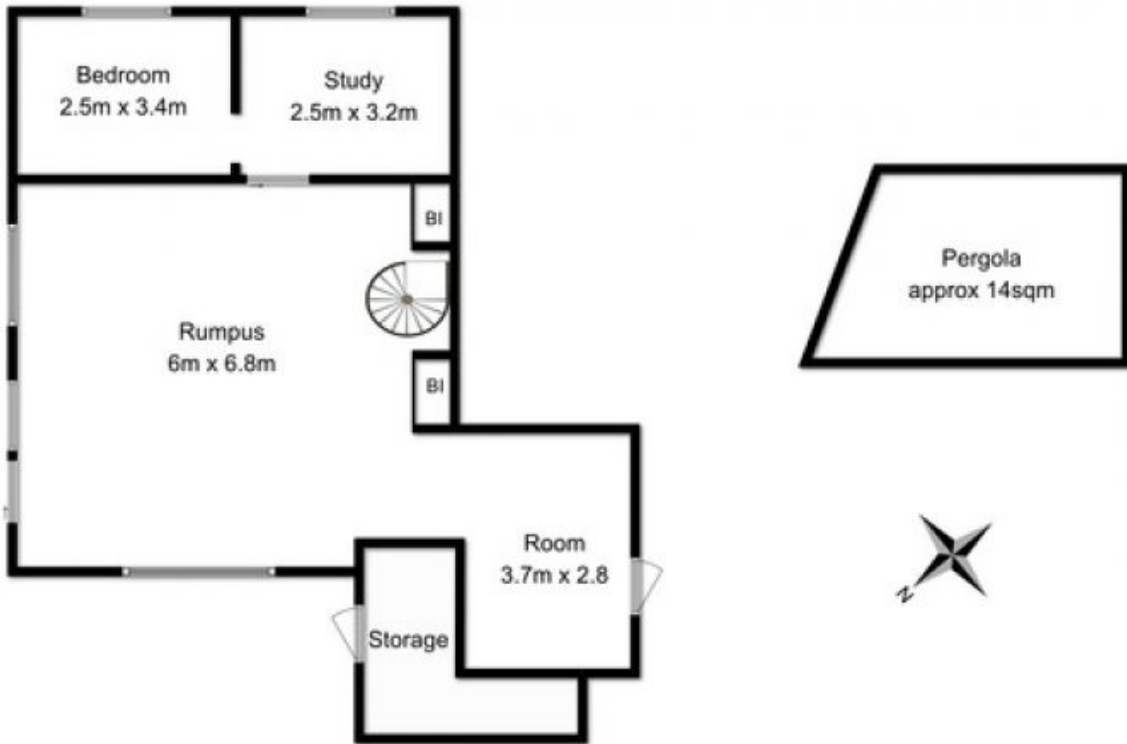

Floor Area approx: 204sqm

This floorplan is a sketch for illustration only

Not to scale

All measurements are internal and approximate

Produced by open2view.com for Ripple Realty