



49 Maple Avenue MOONAH, TAS



CHARMING CIRCA 1941 HOME FOR THE ENTERTAINER!

Behind the front picket fence is a fabulous home that has been renovated to reflect today's living standards as each living space flows into each other.

From the entrance you are taken straight into the sunny lounge room with high ceilings and picture rails which then flows into the open plan kitchen/dining area with excellent space for the family dining table.

Adjoining the third bedroom is a terrific sun room, home office space or small sitting room for the third bedroom.

The separate laundry is located just off the kitchen area with a second separate toilet wh

Stuart Gifford
Property Consultant

0419337054

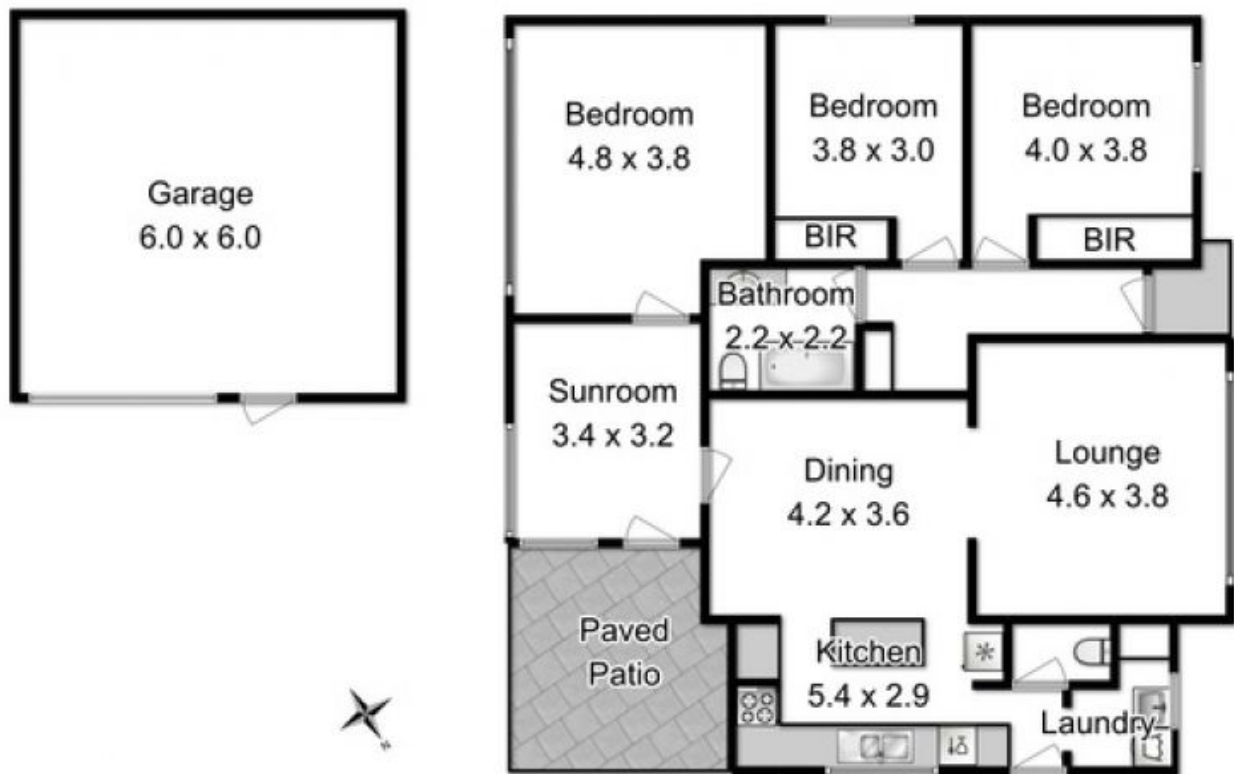

Approx. Floor Area: 120 Sqm

Fixtures and Fittings are for display only and not to scale.

This floor plan is a sketch for illustration.

All measurements are internal and approximate.

Produced by open2view.com

