

16 Rocklyn Avenue MOONAH, TAS



FABULOUS 1950's FAMILY HOME WITH SUN & VIEWS!

A delightful family home that offers an abundance of natural light throughout and separate spaces for the whole family. From the wide entry you are taken into the spacious formal lounge which offers polished timber floor boards and inverter to keep you warm and cool.

Flowing directly from the formal lounge via glass doors is a sundrenched family dining and sitting area which offers panoramic views over Moonah, the Derwent river and Mount Direction which is heated by a freestanding wood heater.

At the rear of the entertaining area is a level grassed area which provides another area f

Council Rates: \$1,400.00/year (approx)

Water Rates: \$1,200.00/year (approx)

Stuart Gifford

Property Consultant

0419337054

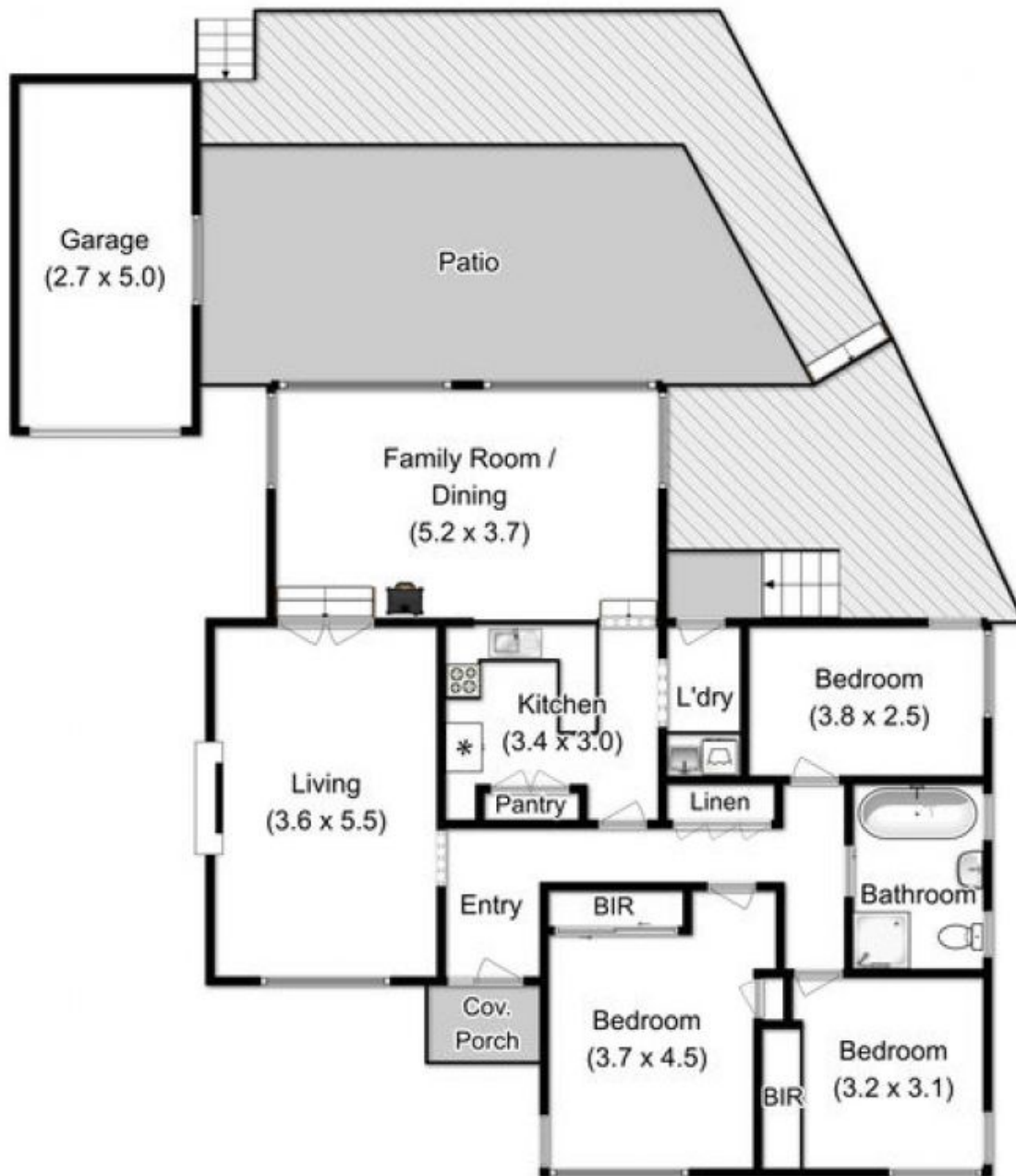

Total Approx. Floor Area : 121 sqm
Total Approx. Outbuilding Area : 17 sqm



All measurements are internal and approximate.
This plan is a sketch for illustration, not valuation.
Produced by Open2view.com