



4 Lawley Crescent SOUTH HOBART, TAS



1960's CLASSIC WITH TRANQUIL SURROUNDS

This classic 1960's home has a desirable mid-century modern design aesthetic with many original features and is set amongst verdant surrounds in popular South Hobart. A much loved family home set on a generous allotment of 1604sqm with additional stair access from Strickland Avenue, this property seeks its next family to move in and enjoy the tranquil gardens and harness the potential this well built house offers.

Council Rates: \$800.00/year (approx)

Water Rates: \$1,964.00/year (approx)

Penny Trewin

0408 505 470

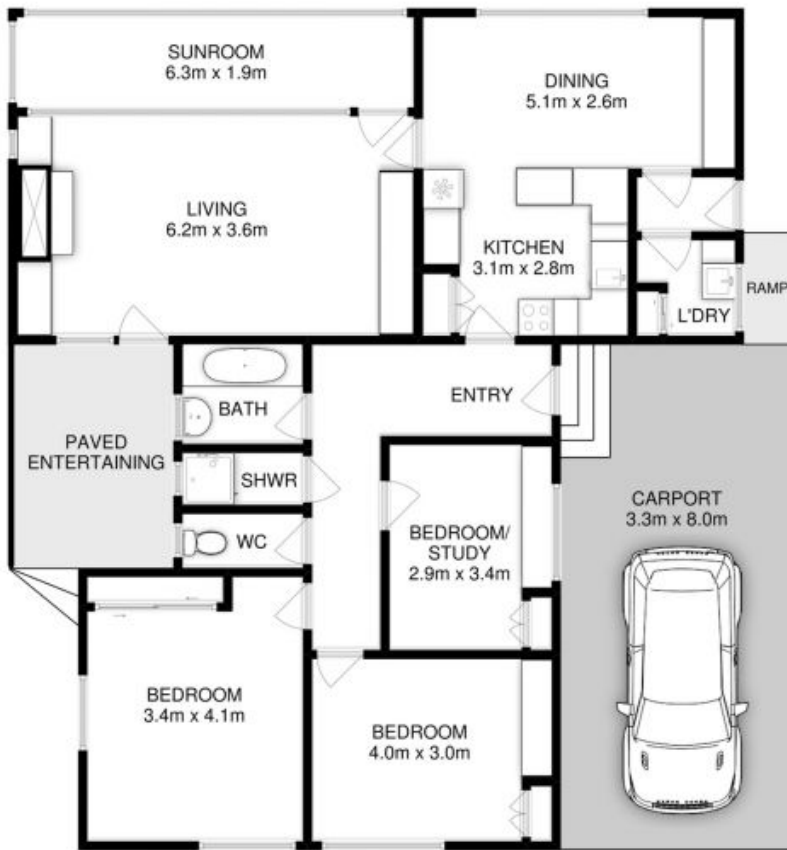

RIPPLE

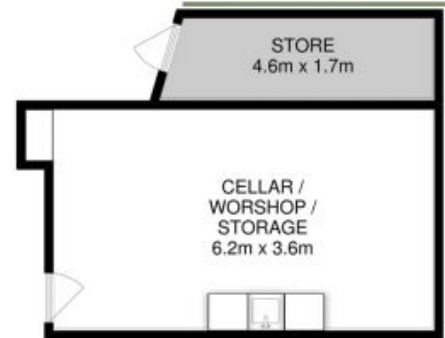

All measurements are internal and approximate.
 This plan is a sketch for illustration, not valuation.
 Produced by Open2view.com for Ripple.

Approx. floor area : 125 sqm
 Approx. outbuilding area : 23 sqm

