



2/323 Churchill Avenue SANDY BAY, TAS



1



1

CONTEMPORARY LIVING WITH SUPERB WATER VIEWS

Desirably located in a sought after pocket of Sandy Bay overlooking the Derwent River to capture picturesque water views, this impressive one bedroom apartment has stylish contemporary interiors and will appeal to purchasers seeking a low maintenance home they can move into, relax and enjoy immediately.

Mel Shutt

Property Consultant

0428428884

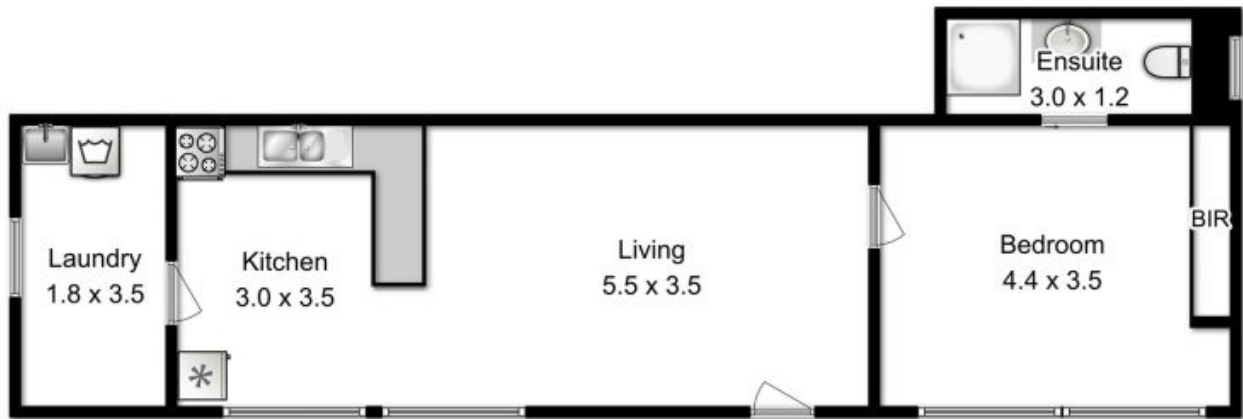

All measurements are internal and approximate.
This plan is a sketch for illustration, not valuation.
Produced by Open2view.com for Ripple.

Approx. floor area : 60 sqm

