



7/6 Peppo Court GLENORCHY, TAS

 3

 1

 1

LOW MAINTENANCE LIVING AT ITS BEST!

Privately positioned at the rear of the complex and enjoying an elevated north facing position to capture all day sun and views all the way to the river, this immaculately presented townhouse offers a flexible floorplan and relaxed lock up and leave lifestyle. Suited to first home buyers, downsizers or investors seeking to add to their portfolio, this is an appealing property providing comfort and convenience.

Mel Shutt

Property Consultant

0428428884

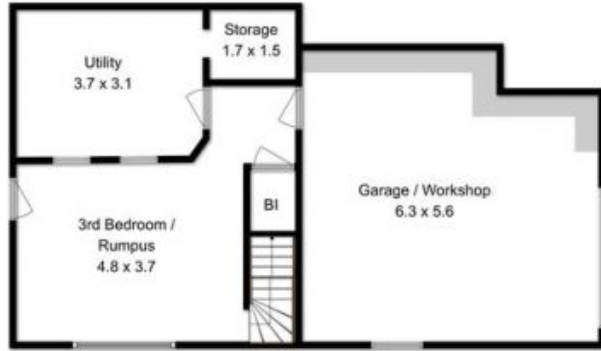

All measurements are internal and approximate.
This plan is a sketch for illustration, not valuation.
Produced by Open2view.com for Ripple.

Approx. floor area : 140 sqm
(excluding Garage/workshop and deck)