



3/12 Risdon Road NEW TOWN, TAS



2



1



1

## Brilliant location

Located in a remarkably quiet position at the rear of a small and well-presented complex, this immaculate townhouse offers absolute convenience for those seeking low maintenance living with easy access to everything!

This quality home built in 1995, offers a spacious open plan living area. The functional kitchen has plenty of storage and bench space, providing ample room for foodies to get creative; and the generous lounge looks out over the private, fenced rear yard.

There are two spacious bedrooms, both with built in wardrobes, and a bathroom with separate toilet.

Never suffer from the winter cold - with both underfloor electric heating and a reverse cycle air conditioner, you will always feel warm and cozy. The property also has NBN connect

## Mel Shutt

Director and Property Consultant

0428428884

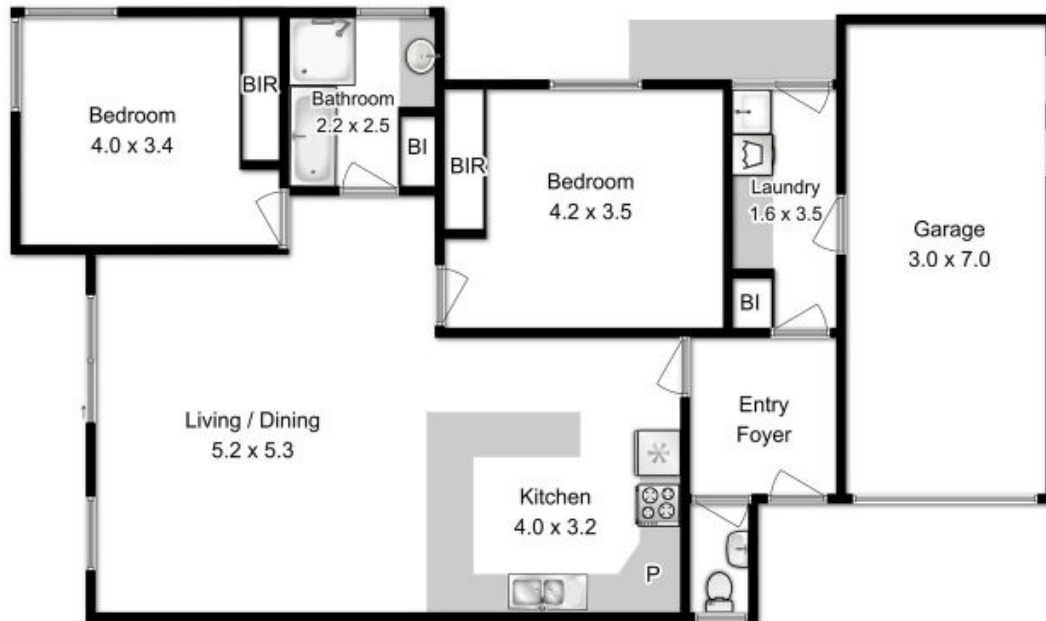

All measurements are internal and approximate.  
 This plan is a sketch for illustration, not valuation.  
 Produced by Open2view.com for Ripple.

Approx. floor area : 122sqm  
 (including garage)

