



171 Brooker Avenue GLEBE, TAS



4



2



2

## Contemporary, comfortable and convenient

Perfectly positioned between North Hobart and the city centre and featuring sweeping views of central Hobart and Mount Wellington, this unique family home is sure to impress.

Built in 2005 to a distinctive and contemporary design, this impeccably presented 3 to 4 bedroom Colorbond home is set over three levels, and utilises a blend of open plan living and private 'retreat' spaces with great success.

The middle level of the property includes a sunny and spacious living room with a deck at the front of the property, which makes the most of the stunning views.

Two comfortable bedrooms, both with built-in wardrobes; a crisp white bathroom with corner spa bath; plus a study nook in the foyer area at the top of the stairs are all located on

### Mel Shutt

Director and Property  
Consultant

0428428884

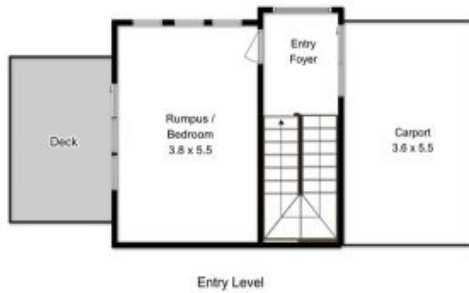
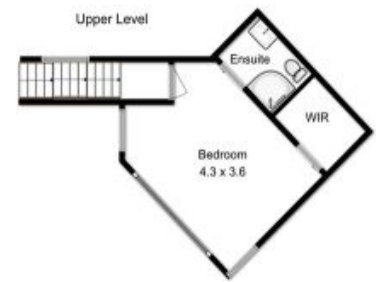
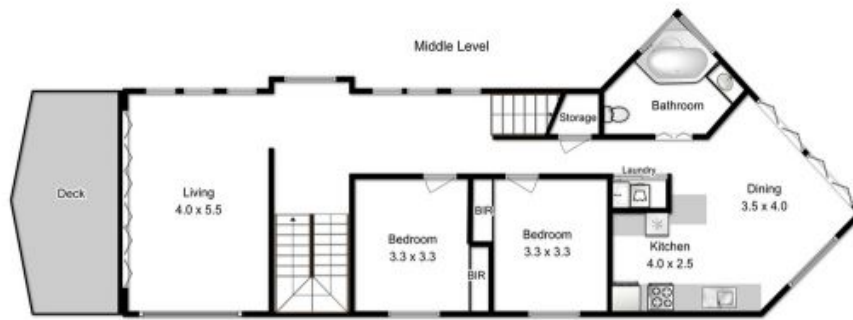

All measurements are internal and approximate.  
This plan is a sketch for illustration, not valuation.  
Produced by Open2view.com for Ripple.

Approx. floor area : 183 sqm

