



7 Karingi Court WEST MOONAH, TAS



An entertainers home with panoramic views and sun

Originally constructed in 1957 this home offers more than meets the eye and has been renovated and extended to take full advantage of the brilliant views and northerly aspect the home offers.

From the wide entrance foyer you are taken into the hub of the home with living areas linked to each other making entertaining in this home very easy.

The property offers excellent hard stand parking at the front of the home plus there is a

Stuart Gifford
Property Consultant

0419337054

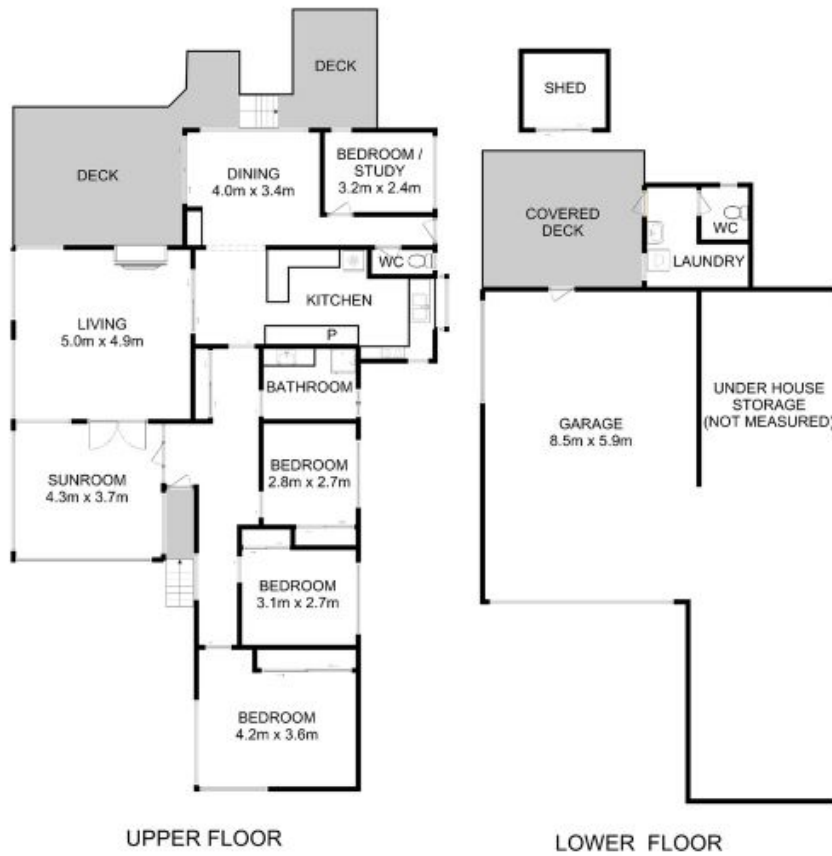

UPPER FLOOR

LOWER FLOOR

All measurements are internal and approximate.
 This plan is a sketch for illustration, not valuation.
 Produced by Open2view.com for Ripple.

Approx. floor area : 230 sqm (inc. garage & l'dry)
 Approx. outbuilding area : 6 sqm

