



12 Renfrew Circle GOODWOOD, TAS



## Blink and you will miss it

Welcome to 12 Renfrew Circle Goodwood a property that needs no introduction given the enviable lifestyle for first home buyers and investors with such a short commute to either the Hobart or Glenorchy CBD. Not to mention with nearby playgrounds and walking tracks it easy to see why Goodwood has grown in its popularity.

This fully fenced, weatherboard home shrouded in gorgeous gardens is sure to attract a LOAD of attention in the current market so this is an open home you MUST NOT MISS!

Beautifully presented throughout this family home has undergone recent renovations over the years - most recently the large double garage ideal for your workshop or home studio.

## Warwick Page

Director & Real Estate Agent

0474122717

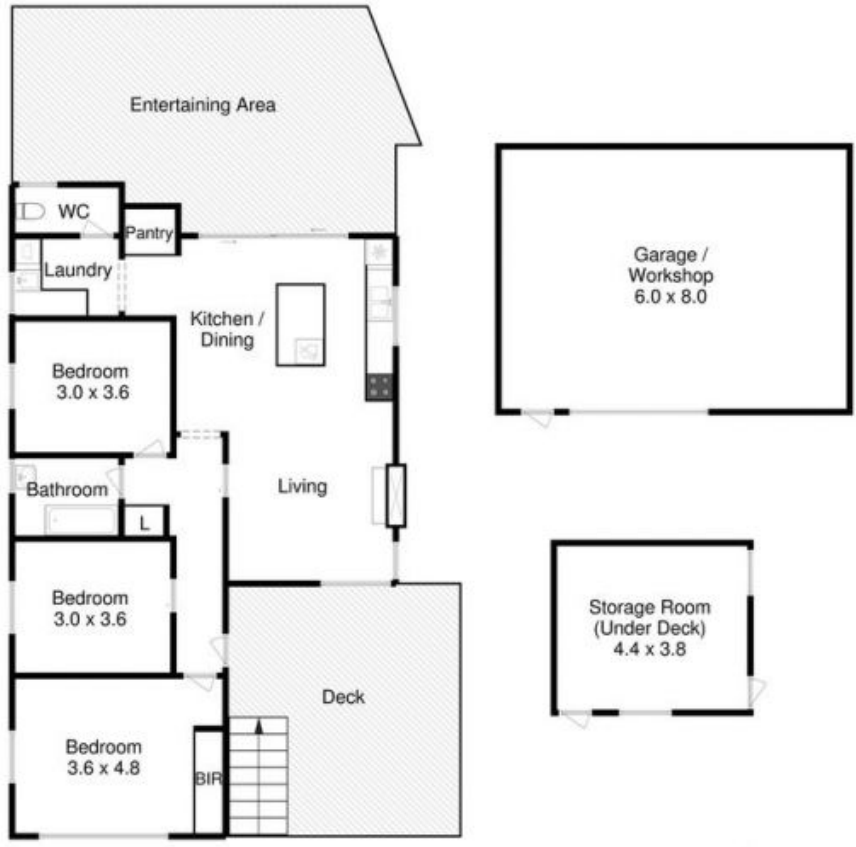

All measurements are internal and approximate.  
 This plan is a sketch for illustration, not valuation.  
 Produced by Open2view.com for Ripple.

Approx. floor area : 109 sqm  
 Approx. outbuilding area : 65 sqm

