

4 Easton Avenue WEST MOONAH, TAS

 2
  1
  3

Stylish, sunny and studio

Basking in all-day sun and extensively renovated, this glorious 1954-built property is a perfect example of modern and stylish living with reminders of its original charm. Offering flexible living arrangements, a private chalet is additional to the spacious two-bedroom main dwelling and generous outdoor spaces, all close to the many amenities that ever-popular Moonah has to offer.

The sleek and functional kitchen includes solid timber benchtops, a self-cleaning oven, induction cooktop, dishwasher and oodles of storage - as well as ample space for family dining.

Outside, the cosy chalet offers a fantastic extra living space, third bedroom, study plus a timber deck; with the flexibility to utilise this area to suit your family as a home off

Mel Shutt

Property Consultant

0428428884

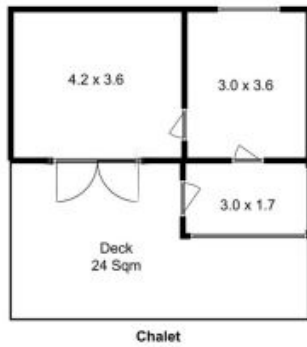

Chalet

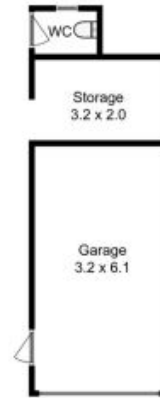
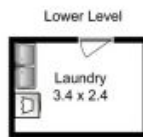

All measurements are internal and approximate.
 This plan is a sketch for illustration, not valuation.
 Produced by Open2view.com for Ripple.

Approx. floor area : 94 sqm
 Approx. Chalet area : 34 sqm