



12 Leila Street NEW NORFOLK, TAS



3



2



1

Nothing but Positives in New Norfolk

What a great way to start your property journey whether it be your first home or your first investment 12 Leila Street New Norfolk will tick so many boxes. The property is situated on a low maintenance and level block set back from the street ensuring a quiet and peaceful life style. Close to schools, public transport and just Short drive to the New Norfolk CBD where you can find everything you need or take a 30-minute commute to the city of Hobart.

Please contact Warwick for further information.

"We have obtained all information in this document from sources we believe to be reliable;

Warwick Page

Director & Real Estate Agent

0474122717

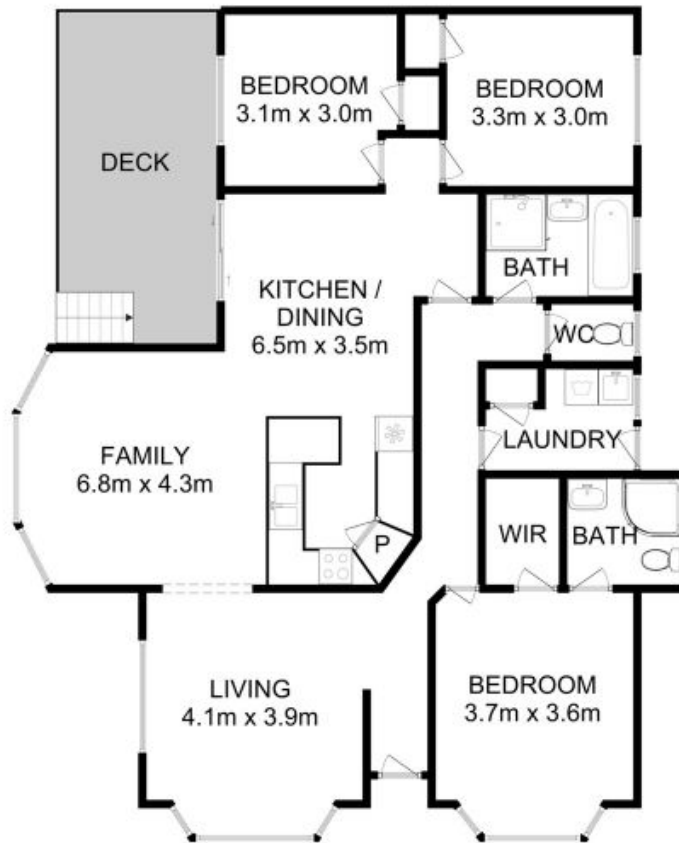

All measurements are internal and approximate.
 This plan is a sketch for illustration, not valuation.
 Produced by Open2view.com for Ripple.

Approx. floor area : 133 sqm