



2/67A Strickland Avenue SOUTH HOBART, TAS



3



1



2

Superb South Hobart along the rivulet

This is truly a special place to live - where else could you live within 5 minutes' drive of a capital city and have the chance to see a platypus at the bottom of the garden? South Hobart has so much to offer, and this exceptional property is ideally located with these amenities close at hand. This is an opportunity not to be missed.

Nestled at the foot of iconic kunanyi/Mt Wellington and just minutes away from vibrant South Hobart, this unique property set amongst quiet bushland offers a fantastic opportunity for those seeking a tranquil hideaway with easy access to the great outdoors.

The serene and sunny living room has plentiful windows that provide an exquisite outlook, and there's a cozy wood fire, plus a reverse cycle air conditioner for warmer months. Step

Council Rates: \$1,400.00/year (approx)

Water Rates: \$1,000.00/year (approx)

Warwick Page

Director & Real Estate Agent

0474122717

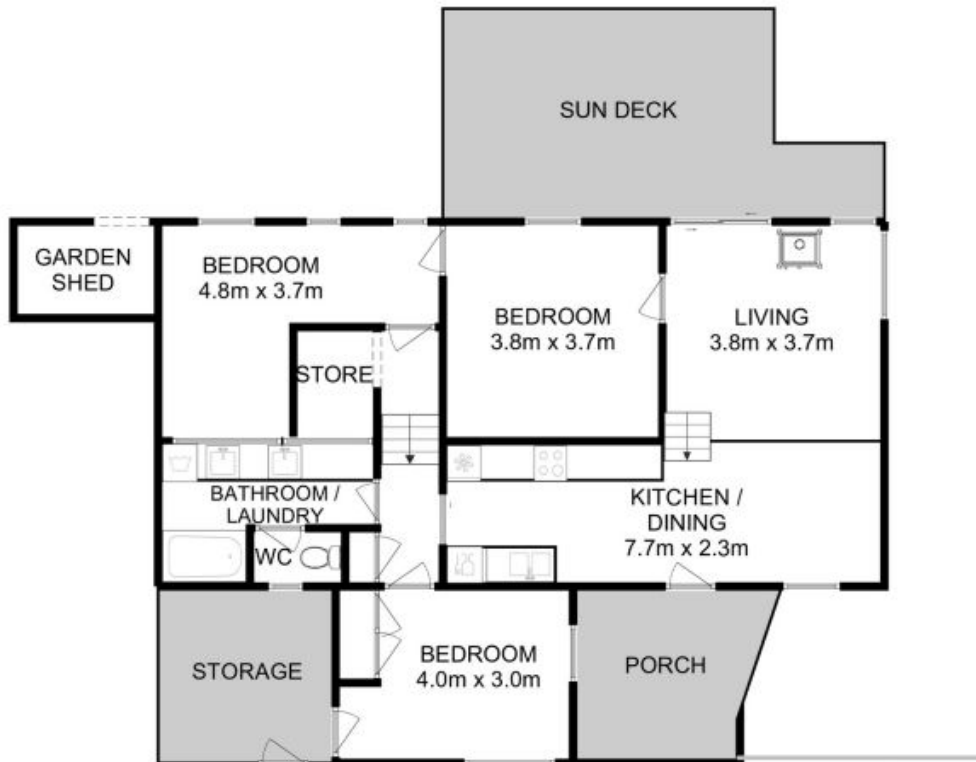

All measurements are internal and approximate.
This plan is a sketch for illustration, not valuation.
Produced by Open2view.com for Ripple.

Approx. floor area : 104 sqm

